

# RECESSED CAN RETROFITS FOR 6" CANS AND LARGER

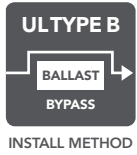

## flexible 4-pin can retrofit

telescoping horizontal to vertical adapter



LED-7342

- 25W replaces up to 42W CFL.
- Appealing design delivers lumens via 140° beam angle.
- Rated for damp locations and in open fixtures only.
- Efficient die-cast aluminum heat sink keeps the lamp running cool.
- Includes 2.9" vertical extender and telescoping horizontal to vertical adapter (shown here).
- Available in 2700, 3500, and 4000K

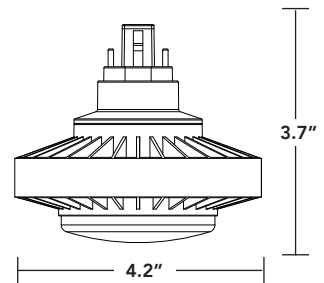

PART #	UPC	REPLACES	WATTAGE	LUMENS	CCT (K)*	BASE
LED-7342-27K-G2	844006023706	42W CFL	25W	2000	2700K	G24q/GX24q
LED-7342-35K-G2	844006023713	42W CFL	25W	2500	3500K	G24q/GX24q
LED-7342-40K-G2	844006023720	42W CFL	25W	2500	4000K	G24q/GX24q



FOR PRODUCT INFO ("LED" MODEL #) CONTACT.....Light Efficient Design • 188 S. Northwest Highway • Cary, IL 60013 • 847.380.3540 • led-llc.com  
 FOR PRODUCT INFO ("RP" MODEL #) CONTACT.....RemPhos by Light Efficient Design • 30 Log Bridge Road, Building 200 • Middleton, MA 01949 • 877.997.3674 • remphos.com

02.01.19 Information is subject to change without notice.